

LOC		DIST		REVISIONS			
P	LTR	DESCRIPTION	DATE	DWN	APVD		
C1		REVISED PER ECO-11-005140	02APR11	RK	HMR		

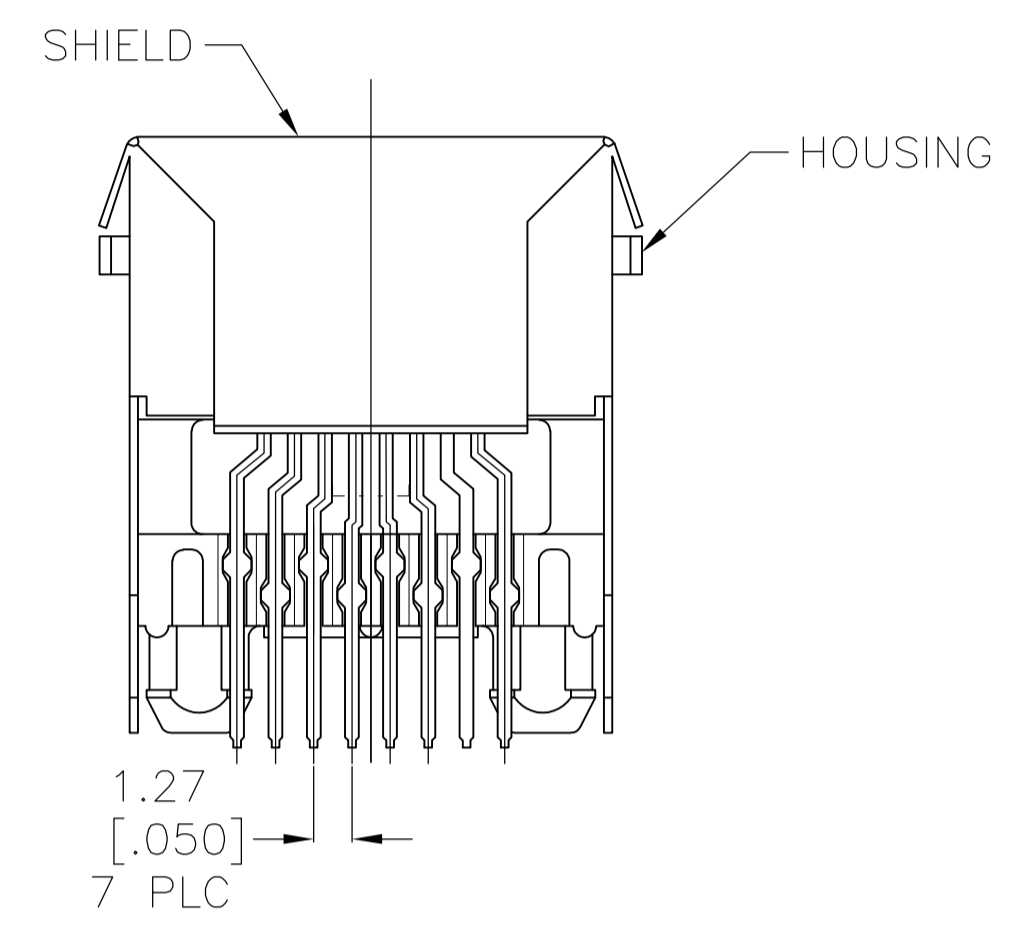

- MATERIAL:
 HOUSING – POLYESTER MOLDING COMPOUND, COLOR: BLACK
 TERMINALS – 0.35[.0138] THICK PHOS BRONZE PLATED WITH 1.27 μ m[.000050] MIN THICK GOLD IN LOCALIZED AREA AND 3.81 μ m[.000150] MIN THICK MATTE TIN IN SOLDER AREA OVER 1.27 μ m[.000050] MIN THICK NICKEL UNDERPLATE
 SHIELD – COPPER ZINC ALLOY PLATED WITH 3.0 μ m[.000120] MIN THICK REFLOWED TIN.

2 CAVITY CONFORMS TO FCC RULES AND REGULATIONS PART 68 AND REA BULLETIN 345-81, PE-76 SPECIFICATION FOR MODULAR TELEPHONE HARDWARE.

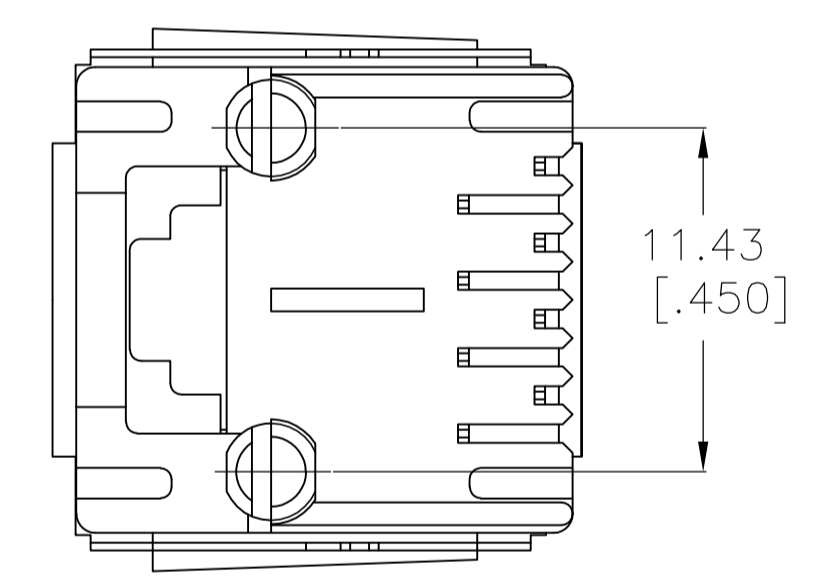
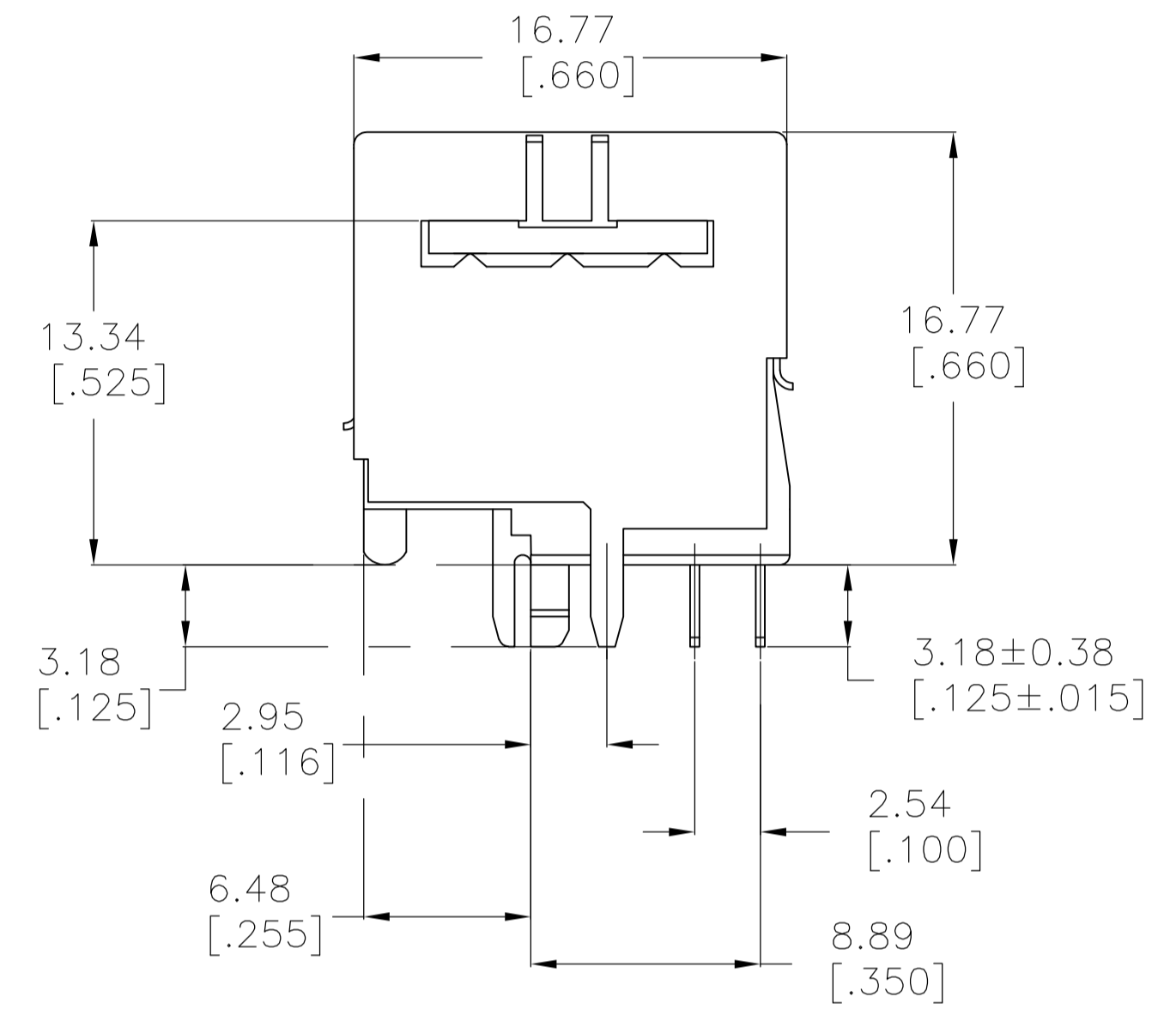
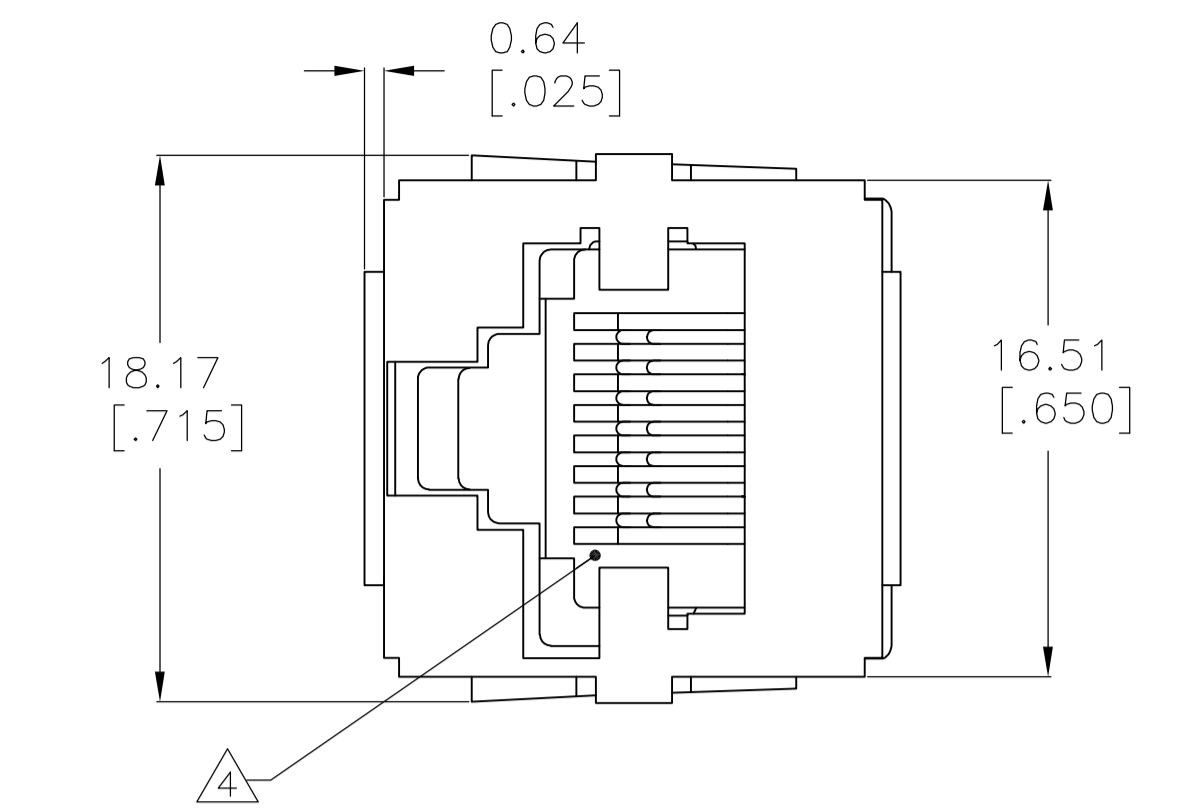
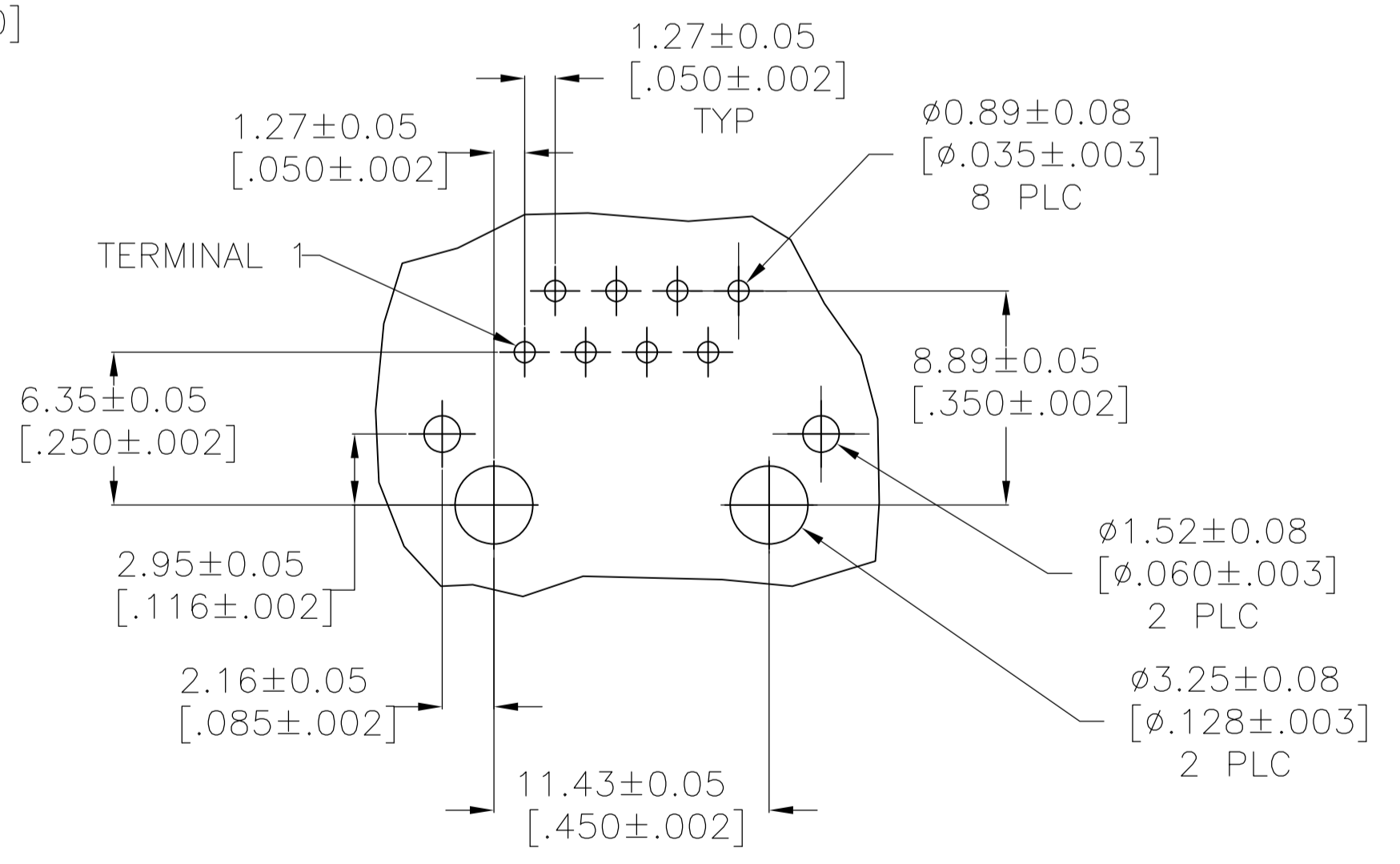

RECOMMENDED PRINTED CIRCUIT BOARD LAYOUT COMPONENT SIDE SHOWN

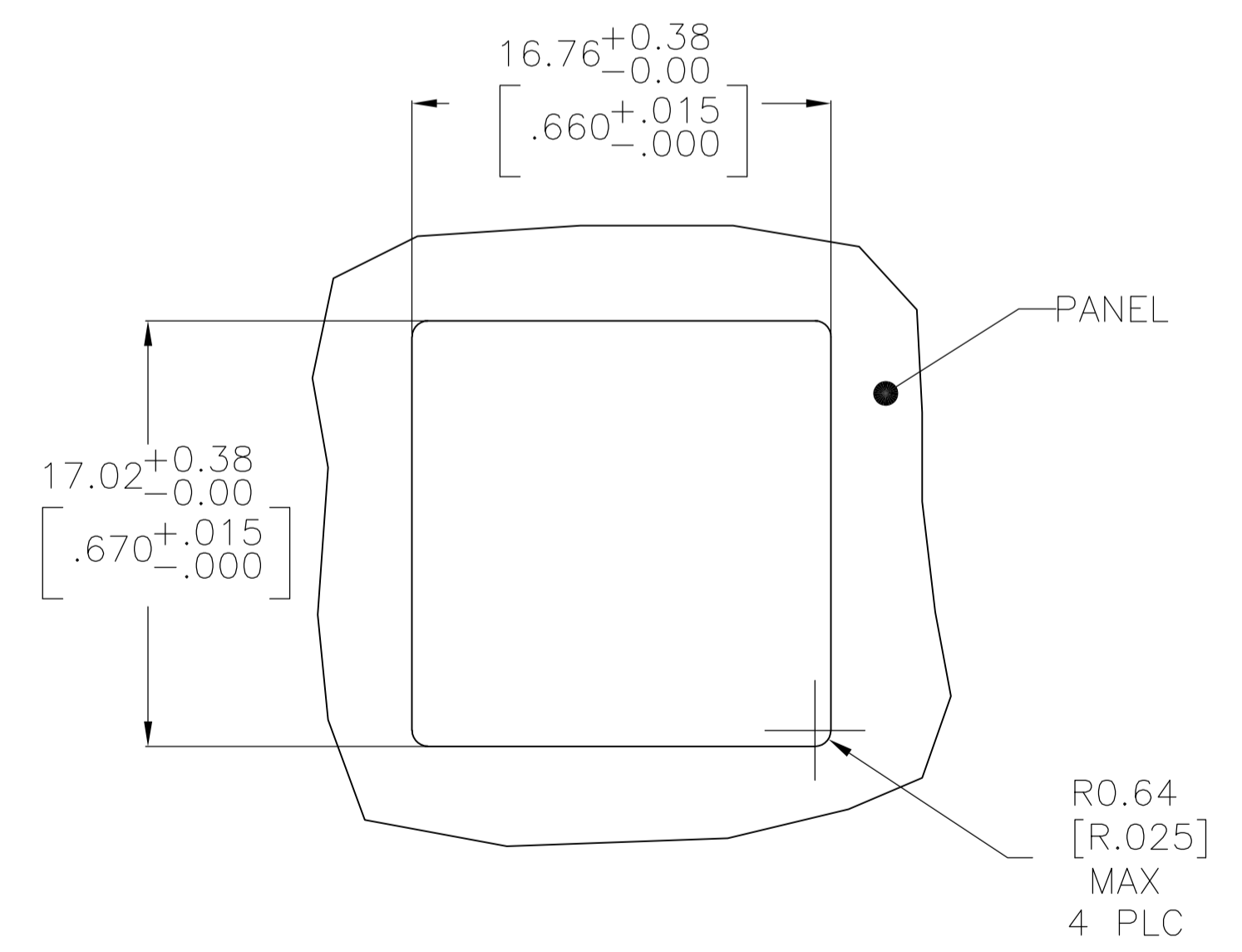

RECOMMENDED PANEL CUTOUT

5557730-1
PART NUMBER

THIS DRAWING IS A CONTROLLED DOCUMENT.		DIN 01 STRAUSSER/LA MAYER 22APR2005		CHK J.WESTMAN 22APR2005		APVD S.FLICKINGER 22APR2005		NAME		MODULAR JACK ASSEMBLY, TOP ENTRY, 8 POSITION, FLANGELESS, SHIELDED, KEYED WITH PANEL STOPS, PANEL AND PCB GROUNDS	
DIMENSIONS: mm [INCHES]		TOLERANCES UNLESS OTHERWISE SPECIFIED:		0 PLC ± -		1 PLC ± -		2 PLC ± -		3 PLC ± 0.13[.005]	
MATERIAL SEE NOTE 1		FINISH SEE NOTE 1		WEIGHT -		SIZE A1		CAGE CODE 00779		DRAWING NO 5557730	
				CUSTOMER DRAWING		SCALE 4:1		SHEET 1 OF 1		REV C1	